

TOWNSHIP OF CENTRE WELLINGTON NOTICE OF A COMPLETE APPLICATION TO AMEND A ZONING BY-LAW

The Township of Centre Wellington has received an application to amend the Township of Centre Wellington Zoning By-law (File RZ06/18). This application has been deemed complete and this Notice of Complete Application is being given in accordance with the requirements of the Planning Act, R.S.O. 1990. The subject lands are 6542 Gerrie Road and 6560 Gerrie Road in Elora. An application for draft plan of subdivision has been received by the County of Wellington. The County's application number is 23T-18002.

Purpose and Effect

The purpose of the proposed Zoning By-law Amendments is to change the current zoning of the subject land from Agricultural (A) and Environmental Protection (EP) to Residential (R1B, R1B Exception, R1C, R1C Exception, R2, R4 and R4 Exception), Open Space (OS), Future Development (FD) and Environmental Protection (EP). The effect of the proposed zoning by-law amendment is to accommodate the development of a proposed draft plan of subdivision (County of Wellington File Number: 23T-18002). The proposed draft plan of subdivision consists of lots and blocks for up to 251 units including a mix of single detached dwellings, cluster townhouses, an apartment, parks, open space, storm water management ponds and walkways.

Additional Information

For more information about this matter, including information about preserving your appeal rights, contact Chantalle Pellizzari, Planning Coordinator at the contact information provided below.

- By Phone at 519-846-9691 x241
- By Email at cpellizzari@centrewellington.ca
- In person at 1 MacDonald Square, Elora

Details of this application can be viewed on the Township Website at:
<https://www.centrewellington.ca/currentapplications/>

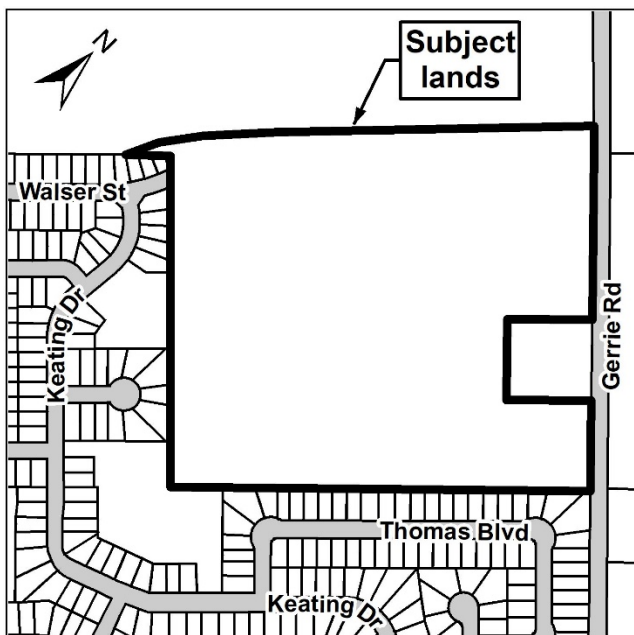

DATED AT THE TOWNSHIP OF CENTRE WELLINGTON THIS 5th DAY OF JULY, 2018.

Kerri O'Kane,
Manager of Legislative Services/Clerk
Township of Centre Wellington
1 MacDonald Square
Elora, Ontario N0B 1S0
Phone: (519) 846-9691 x243
Email: kokane@centrewellington.ca